

# DESIGN CHARRETTE AND COMMUNITY NETWORKING

Earl Hatcher Commons (formerly Magnolia Glen)

THURSDAY, OCTOBER 17, 2013

4:30-5:30 PM, PRE-EVENT TOUR OF THE EARL  
HATCHER COMMONS

Join us for a pre-event tour of the Earl Hatcher Commons  
Facility located at 3815 Gulf Fwy., Houston, TX 77003.

5:30-8:00 PM, DESIGN CHARRETTE AND  
COMMUNITY NETWORKING

Be a part of an evening of design and community networking  
to discuss this innovative social living, permanent supportive  
apartment housing complex located at the EB Cape Center  
at 4501 Leeland St., Houston, TX 77023.

## DIRECTIONS:



From the *Earl Hatcher Center* take Winchester north toward Hussion St and make a right onto Hussion. Continue on Hussion St. for a half mile to Leeland St. and turn right. Continue on Leeland St. for .7 miles to the S Lockwood Dr. intersection. Make a left onto S Lockwood Dr. and continue 200ft. After 200ft make a left onto Telephone Rd. The *EB Cape Center* will be on the right or call the EB Cape Center at 832-395-4900.

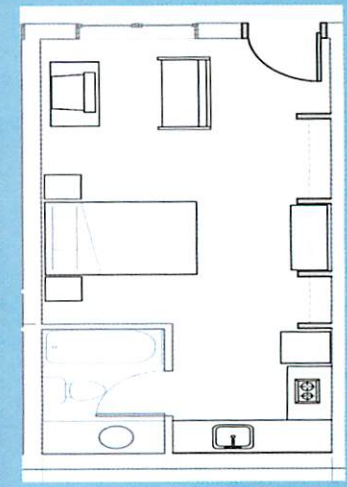

For More Information:

[www.csd.hctx.net/Article.aspx?ArticleID=1876](http://www.csd.hctx.net/Article.aspx?ArticleID=1876) or contact Walter at [plancomments@csd.hctx.net](mailto:plancomments@csd.hctx.net) or 713-578-2000.